

Low-Risk Neonatal Nursing Review Agenda

Day 1

8:00-8:30 What About the Test? Understanding NCC



8:30-9:15 Factors Affecting the Fetus and Newborn
Assessment & Evaluation of Intrauterine Environment
Fetal Anatomy/Physiology
Maternal/Uteroplacental Perfusion
Fetal Assessment Tools

9:15-9:45 Maternal Factors and Complications Affecting the Fetus/Neonate
Perinatal Substance Abuse
Life-Style and Environmental Conditions

9:45-10:00 Break

10:00-10:45 Maternal Factors and Complications (continued)
Medical Conditions
Pregnancy Related Conditions
Complications of Labor



10:45-11:30 General Physiologic Assessment & Complications By Systems
Adaptation to Extrauterine Life (continued)
Gestational Age
Physical Characteristics, Etiologies and/or Risk and Complications

11:30-12:30 Lunch

12:30-13:30 General Physiologic Assessment
Gestational Age (continued)
HEENT
Physical Characteristic, Etiologies, and/or Risk and Complications

13:30-14:15 General Physiologic Assessment (continued)
Integumentary

14:15-14:30 Break

14:30-15:15 General Physiologic Assessment (continued)
Respiratory



15:15-16:00 General Physiologic Assessment (continued)
Cardiac

Day 2

8:00-8:15 Review from Day 1

8:15-9:00 General Physiologic Assessment (continued)
Gastrointestinal

9:00-9:45 General Physiologic Assessment (continued)
Genitourinary

9:45-10:00 Break

10:00-10:45 General Physiologic Assessment (continued)
Musculoskeletal

10:45-11:30 General Physiologic Assessment (continued)
Neurological

11:30-12:30 Lunch

12:30-13:15 General Physiologic Assessment (continued)
Hematologic

13:15-14:00 Newborn Complications
Thermoregulation
Hyperbilirubinemia
Hypoglycemia



14:00-14:15 Break

14:15-15:00 Newborn Complications
Infectious Disease
Bacterial
Viral (TORCH)
STD's

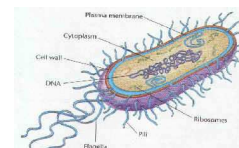

15:00- 15:45 Newborn Nutrition
Breastfeeding
Bottle Feeding

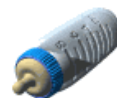

15:45-16:00 Questions: Adjourn

Objectives

1. Identify methods of assessment and evaluation of the fetus during the antepartum period.
2. Understand specific maternal disease processes as each affects the fetus/neonate.
3. Identify life-style and environmental hazards affecting the fetus/neonate.
4. Identify potential fetal/neonatal outcomes associated with perinatal substance abuse.
5. Compare fetal/neonatal circulation.
6. Review physiological changes occurring during the neonate's transition to extrauterine life.
7. Define the components of a complete newborn physical assessment, including normal and abnormal findings.
8. Discuss resuscitation and stabilization interventions for selected neonatal disease processes and/or congenital abnormalities
9. Discuss methods and interpretation of selected clinical laboratory test.
10. Discuss basic physiology and potential complications associated with hyperbilirubinemia and hypoglycemia.
11. Understand the mechanisms of thermoregulation in the newborn as well as methods of heat loss.
12. Describe complications and variations of specific neonatal bacterial and viral infections.
13. Review neonatal nutritional guidelines for both the breast and bottle-fed newborn.
14. Discuss methods of pain assessment in the neonate